

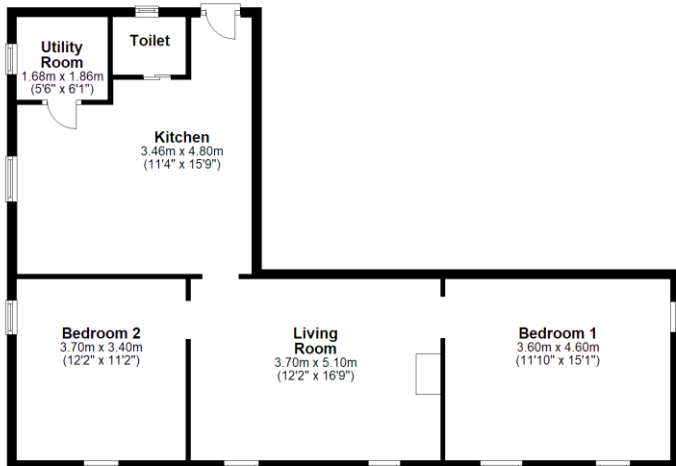

## Chapelhead, 1 acre or thereby, Sanday, KW17 2AY

Chapelhead is a traditional two bedroom cottage with extension and requires extensive modernisation. There are several stores and the land is to grass. Chapelhead sits in 1 acre or thereby and enjoys views across farmland to the sea.

**OFFERS OVER  
£35,000**

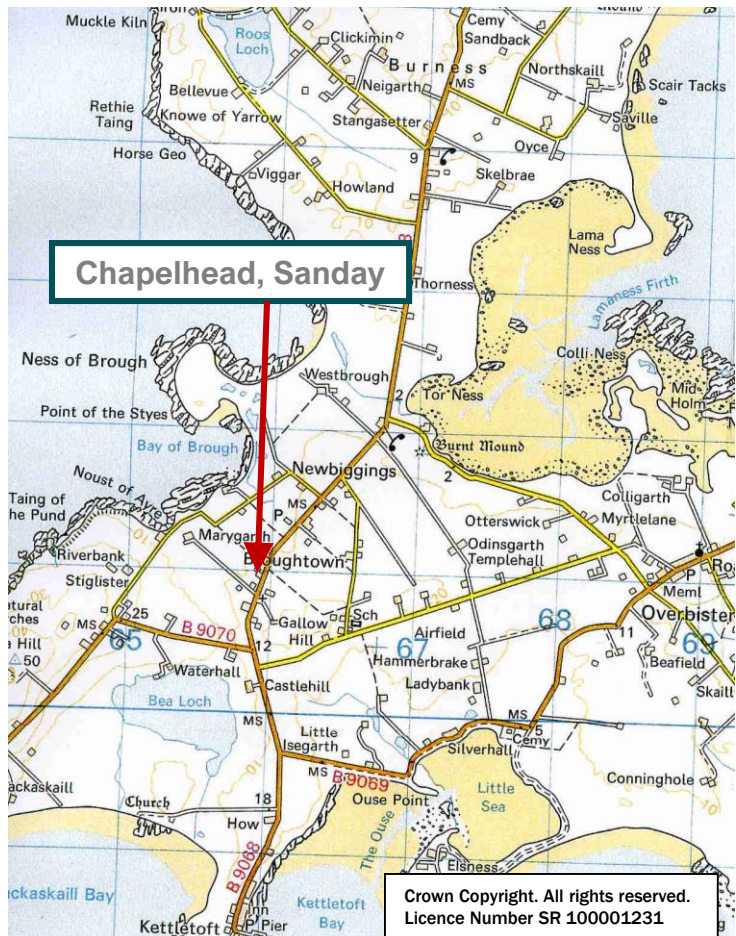

**SERVICES** - Mains water, electricity, private septic tank.

**COUNCIL TAX BAND** - Band A. The Council Tax Band may be reassessed by the Orkney and Shetland Joint Board when the property is sold. This may result in the band being altered.

**ENTRY** - By arrangement.

**FIXTURES AND FITTINGS** – All floor coverings are included in the sale price.

**VIEWING** - For an appointment to view please contact Lows Property Department.

**PRICE** – Offers over £35,000

Further enquiries should be directed to Lows Property Department, with whom all offers should be lodged in writing.



Lows Solicitors – Estate Agents  
 5 Broad Street, Kirkwall, Orkney, KW15 1DH  
 T: 01856 873151 F: 01856 875450 W: [www.lowsorkney.co.uk](http://www.lowsorkney.co.uk)

**CMS**

The following notes are of crucial importance to intending viewers and/or purchasers of the property.

- These particulars do not form part of any offer or contract and all statements and measurements contained herein are believed to be correct but are not guaranteed, and any intending purchaser must satisfy themselves as to their accuracy. Prospective purchasers are advised to have their interest noted through their solicitors as soon as possible in order that they may be informed in the event of an early closing date being set for receipt of offers.
- No responsibility can be accepted for any expenses incurred by intending purchasers in inspecting properties which have been sold or withdrawn.